

PROPOSED EXPANSION AREA  
(2 ACRES)

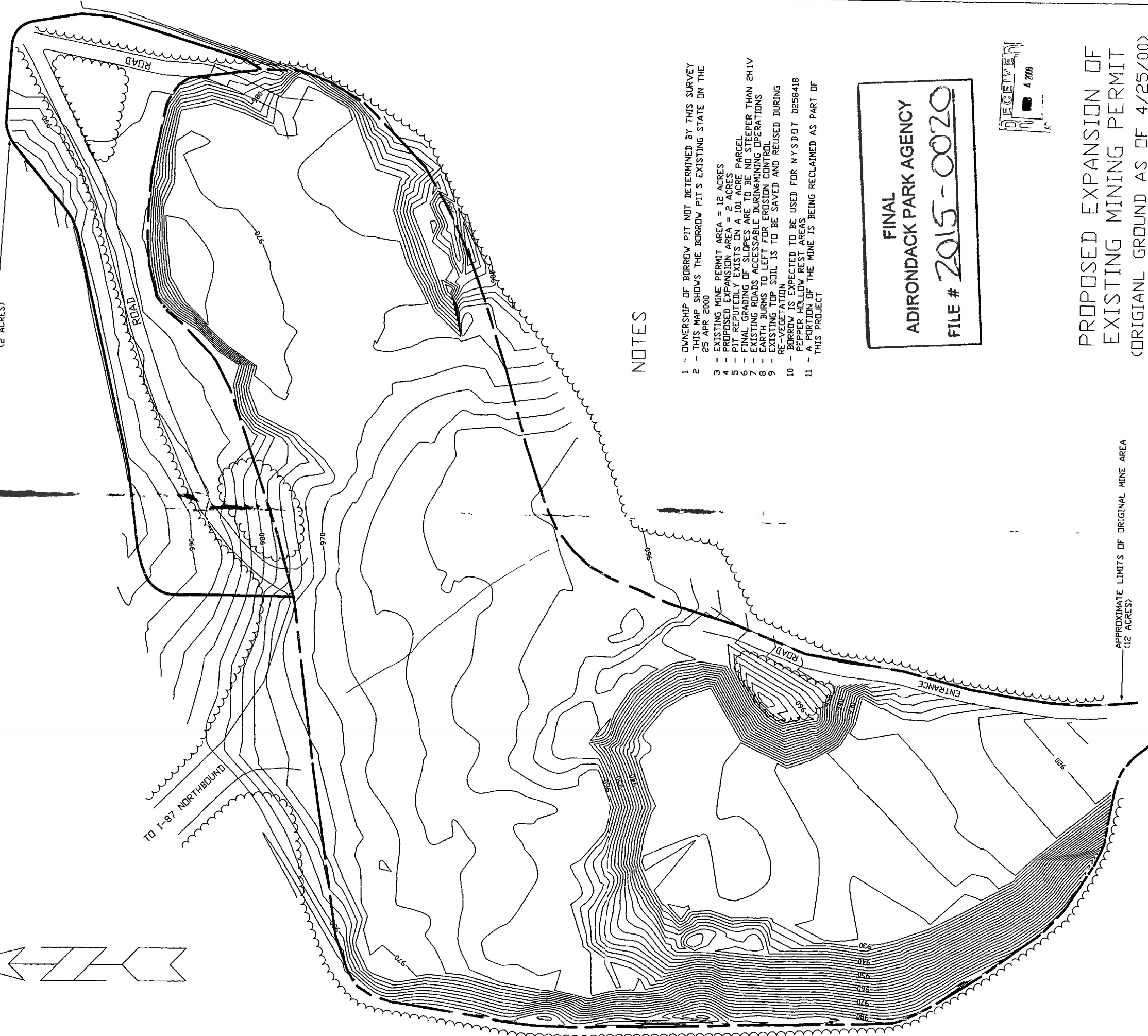

NOTES

- 1 - OWNERSHIP OF BORROW PIT NOT DETERMINED BY THIS SURVEY
- 2 - THIS MAP SHOWS THE BORROW PIT'S EXISTING STATE ON THE 25 APR 2000
- 3 - EXISTING MINE PERMIT AREA = 12 ACRES
- 4 - PROPOSED EXPANSION AREA = 2 ACRES
- 5 - PIT REPUTEDLY EXISTS ON A 101 ACRE PARCEL
- 6 - FINAL GRADING OF SLOPES ARE TO BE NO STEEPER THAN 2H:1V
- 7 - EXISTING ROADS ACCESSIBLE DURING MINING OPERATIONS
- 8 - EARTH BURMS TO LEFT FOR EROSION CONTROL
- 9 - EXISTING TOP SOIL IS TO BE SAVED AND REUSED DURING RE-VEGETATION
- 10 - BORROW IS EXPECTED TO BE USED FOR NYS DOT D258418 REPER-HOLLOW REST AREAS
- 11 - A PORTION OF THE MINE IS BEING RECLAIMED AS PART OF THIS PROJECT

FINAL  
ADIRONDACK PARK AGENCY  
FILE # 2015-0020

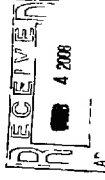

PROPOSED EXPANSION OF  
EXISTING MINING PERMIT  
(ORIGINAL GROUND AS OF 4/25/00)

ESSEX COUNTY    NORTH HUDSON QUAD

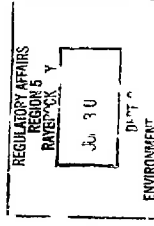

TOPOGRAPHIC SURVEY  
SHOWING THE EXISTING GROUND  
OF A CERTAIN BORROW PIT  
OWNED BY

JOHN KOHLER



Scale 1" = 50'

SURVEY COMPLETED    25 APR 2000    MARC A MANFRED, L.S.  
MAP COMPLETED    04 JUN 2000    MORIAH, NY 12961

